

## STEP 1 PREPARATION

### 1 Components of product

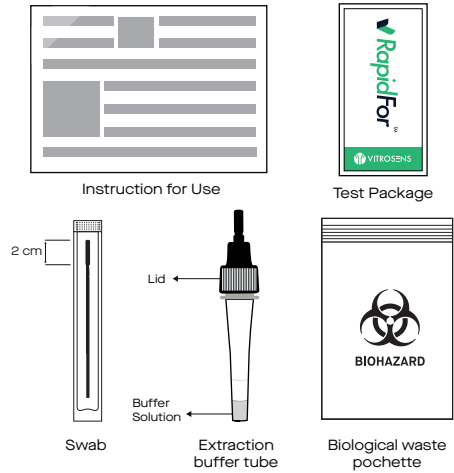

Familiarize yourself with the contents of the test kit in advance without opening the packaging of the components. Make sure to perform the test package contains the test cassette, a bottle with extraction buffer, a sterile swab, waste pochette and information for use.

### 2 Read IFU and Scan QR

Please read the instructions for use carefully before starting the test and scan the QR code to watch "how to use" video



### 3 Before testing

- All components must be brought to room temperature before testing.
- Clear a flat surface and dry it.
- Have a watch ready.
- To obtain accurate results, an opened and exposed Test Card should not be used in a heavily ventilated and moistured area.
- Do not store the test kit in direct sunlight.

**CAUTION:** The test card is for one-time use only and cannot be reused or used by more than one person at a time.



Wash your hand before testing

## STEP 2 SAMPLE COLLECTION & PROCESSING

**CAUTION:** Samples should be used as soon as possible after collection.

### 4 Place the buffer tube into holder

Place the bottle containing the extraction buffer solution into the tube holder and open it.

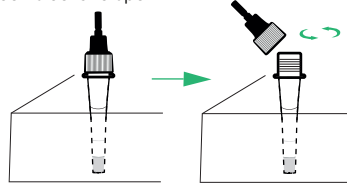

**CAUTION:** Be careful not to spill any of the liquid.

**CAUTION:** Do not drink the extraction solution in the tube. Immediately consult your healthcare professional if you drink it.

### 5 Take the swab

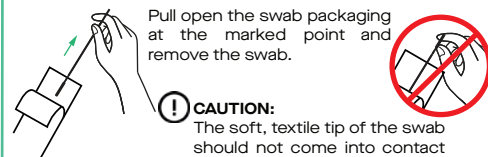

**CAUTION:** The soft, textile tip of the swab should not come into contact with hands or objects.

**CAUTION:** Do not open the swab until you are going to use it in couple minutes.

### 6 Sample collection

Carefully insert the sterile swab 2 cm into one nostril and rotate the swab 3 times close to the inner wall of the nose. Repeat the procedure with the same swab in the other nostril.

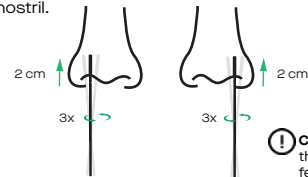

**CAUTION:** Do not insert the swab deeper if you feel strong resistance or pain.

### 7 Insert the swab

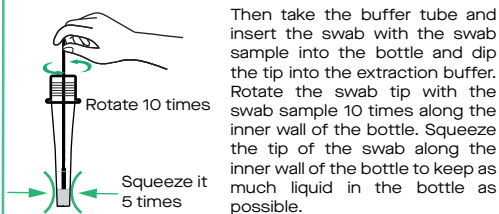

Then take the buffer tube and insert the swab with the swab sample into the bottle and dip the tip into the extraction buffer. Rotate the swab tip with the swab sample 10 times along the inner wall of the bottle. Squeeze the tip of the swab along the inner wall of the bottle to keep as much liquid in the bottle as possible.

- ① \*Make sure that the sample on the swab is detached as completely as possible into the buffer/test liquid.
- ① \*This process should take at least 20 seconds.

## 8 Break off the swab

Break off the upper half of the swab from the breaking point, leaving the lower half in the bottle, and close the cap back.

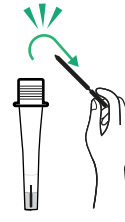

**CAUTION:** If squeezing of tube is not made correctly, sample swab absorbs much more extraction buffer and that will yield wrong results.

## 9 Close and mix the bottle

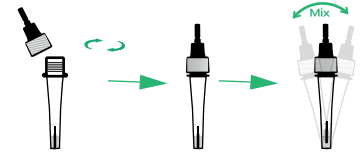

**CAUTION:** Do not drink the sample extraction solution with swab. If you accidentally drink it immediately consult your healthcare professionals.

**CAUTION:** Do not spill any of the sample extraction solution. If you spill it, sterilize the area and if the amount of the sample extraction solution mixture is not enough to perform the test, repeat the test by using new sampling swab and extraction solution tube.

## STEP 3 TEST OPERATION

### 10 Take out the cassette

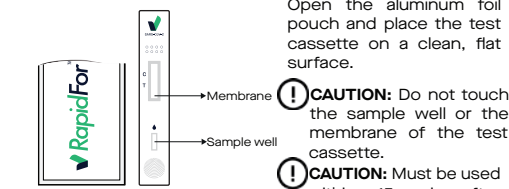

Open the aluminum foil pouch and place the test cassette on a clean, flat surface.

**CAUTION:** Do not touch the sample well or the membrane of the test cassette.

**CAUTION:** Must be used within 15 min after removal from foil pouch.

### 11 Break off the tip

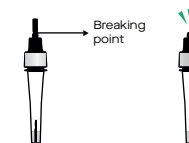

The cap contains an opening, carefully break off the tip of the cap with your thumb, this allows dropwise dispensing of the processed sample during the following test procedure.

### 12 Test Operation

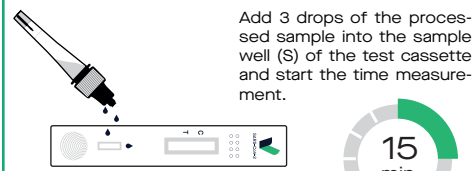

Add 3 drops of the processed sample into the sample well (S) of the test cassette and start the time measurement.



Read the result after 15 minutes.

**CAUTION:** Do not read after 20 minutes.

## STEP 4 INTERPRETATION OF THE RESULTS

This product is for the qualitative detection of SARS-CoV-2 antigen only. Please consult your physician for medical advice before any kind of medical decision.

**Positive** If both C- and T-line are appear, it indicates that SARS-CoV-2 antigen has been detected and the results is positive

If the test result is positive:

- Currently, there is a suspected infection of COVID-19

- Contact your doctor or local health department immediately
- Comply with the local self-isolation guidelines
- Perform PCR test for confirmation

**Note:** The intensity of the color in the test line region will vary depending on the concentration of COVID-19 antigen in the specimen. Therefore, any shade of color in the test region should be considered positive.

**Negative** If there is only a control line (C) appeared and the test line (T) is colorless, it indicates that SARS-CoV-2 antigen has not been detected and the result is negative.

- Continue to comply with all applicable rules regarding contact and protective measures.
- Even if the test is negative, there may be an infection.

- In case of doubt, repeat the test after 1-2 days because the SARS-CoV-2 cannot be accurately detected at all stages of infection.

**Invalid** If the control line (C) is not observed, the test is considered to be invalid whether the test line (T) is visible or not. A new test needs to be performed using a new test device.

If the test result is invalid, it may be caused by incorrect test operation. Please repeat the test. If the test result is still invalid, please contact your doctor or COVID-19 testing center.

## STEP 5 BIOHAZARD WASTE DISPOSAL PROCEDURE

### 13 Clean the area

Sterilize or clean the area where the test is performed.

### 14 Disposal

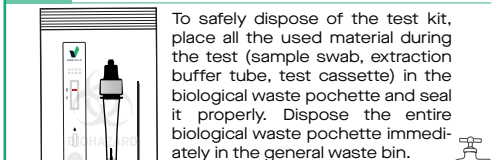

To safely dispose of the test kit, place all the used material during the test (sample swab, extraction buffer tube, test cassette) in the biological waste pochette and seal it properly. Dispose the entire biological waste pochette immediately in the general waste bin.

Wash hands with soap thoroughly or sanitize your hands after handling.



