

SARS-CoV-2 (COVID-19) Antigen Test (Lateral Flow Assay)

Early detection of COVID-19-quick inform of infection status

- Direct detection of virus with sample type of nasopharyngeal or oropharyngeal swab
- Easy to use, no equipment required: visual interpretation of results
- Instant result in 15 mins
- Specificity: 100%; Sensitivity: 89.1%

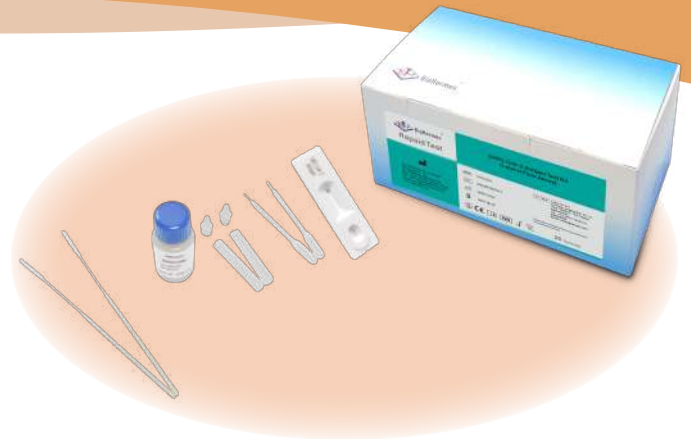

Clinical Value & Principle

This rapid test is used for the in vitro detection of SARS-COV-2 antigen through human nasopharyngeal or oropharyngeal swabs. A quick diagnosis will allow medical staff to treat patient and to control the pandemic more efficiently and expediently.

This test is an Lateral Flow Assay-based application. The colored line reveal the presence of the antigen. The antigen is generally detectable in the samples of the upper respiratory tracts when the acute stage of infection is present.



Application Period of Different COVID-19 Testing Methods

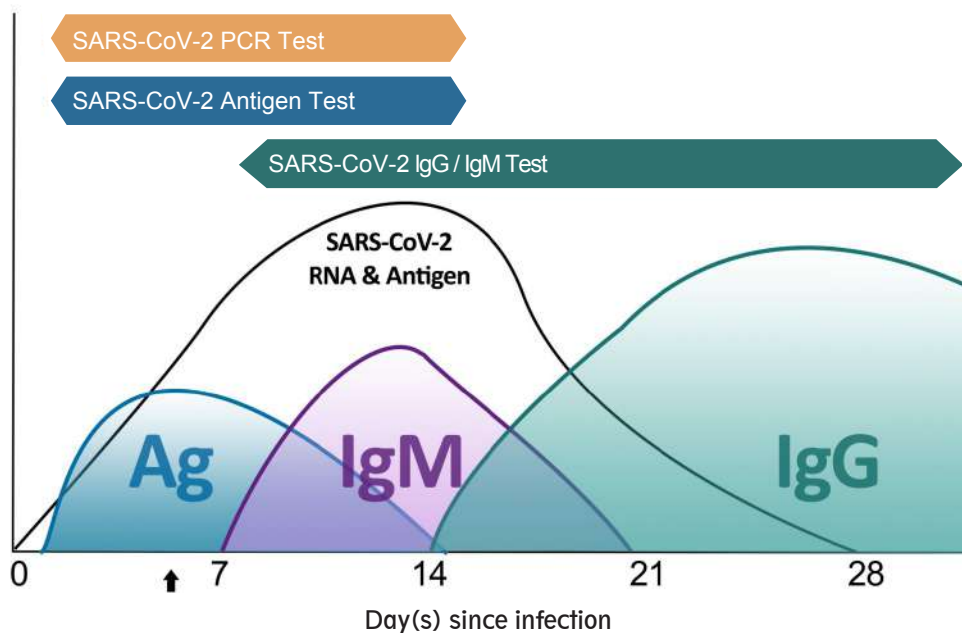

Test Procedure

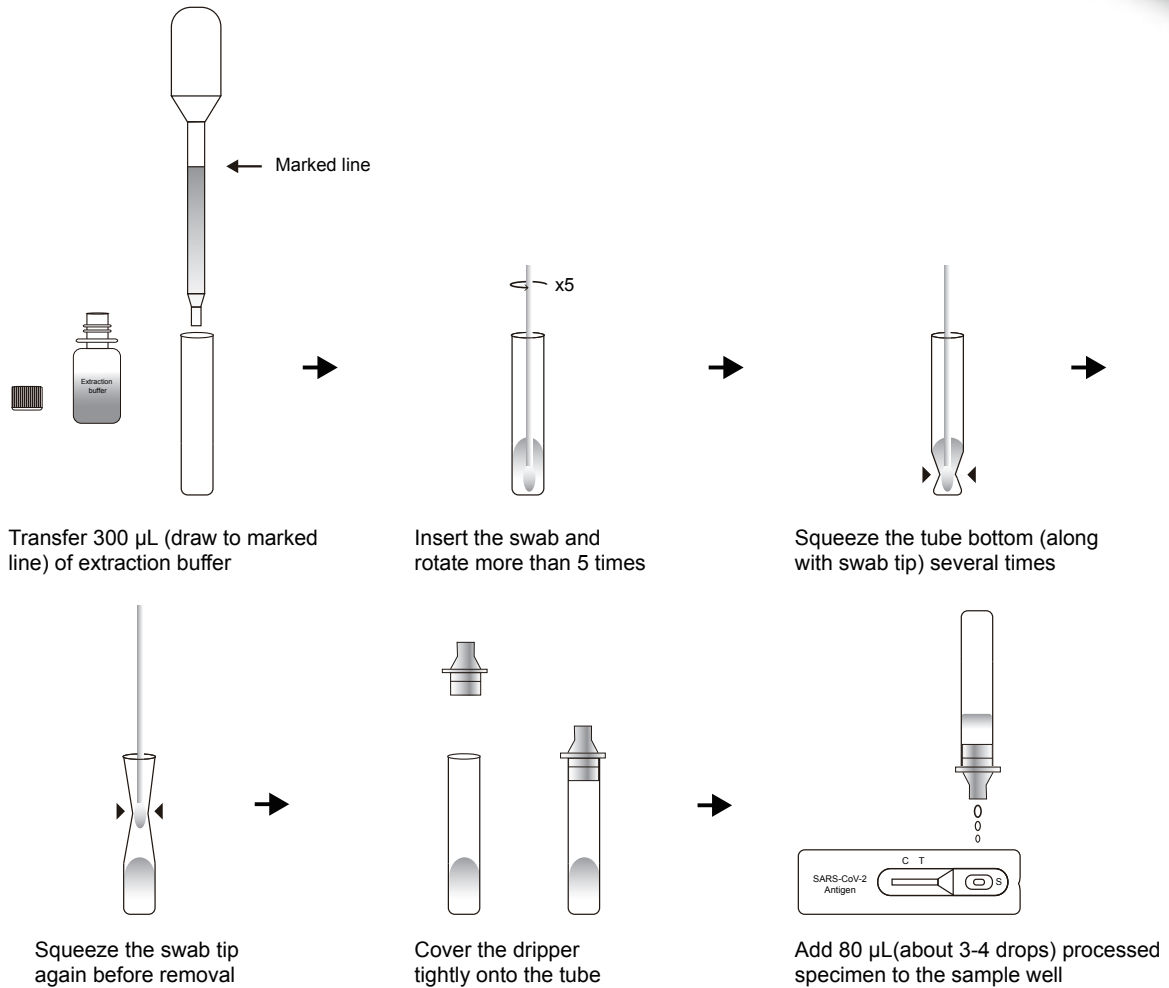

Result Interpretation

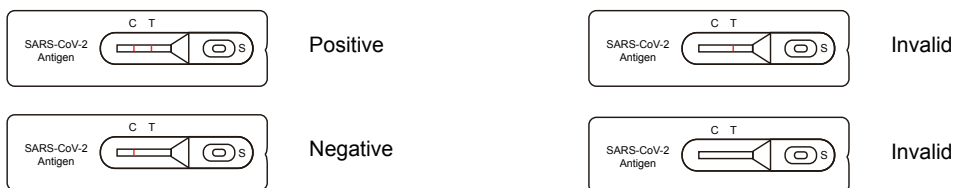

Product Information

Product	Sample Type	Packing Size	Storage Condition	Shelf Life
SARS-CoV-2 Antigen Test (Lateral Flow Assay)	Nasopharyngeal/oropharyngeal swab	25 tests	2-30°C	12 months